

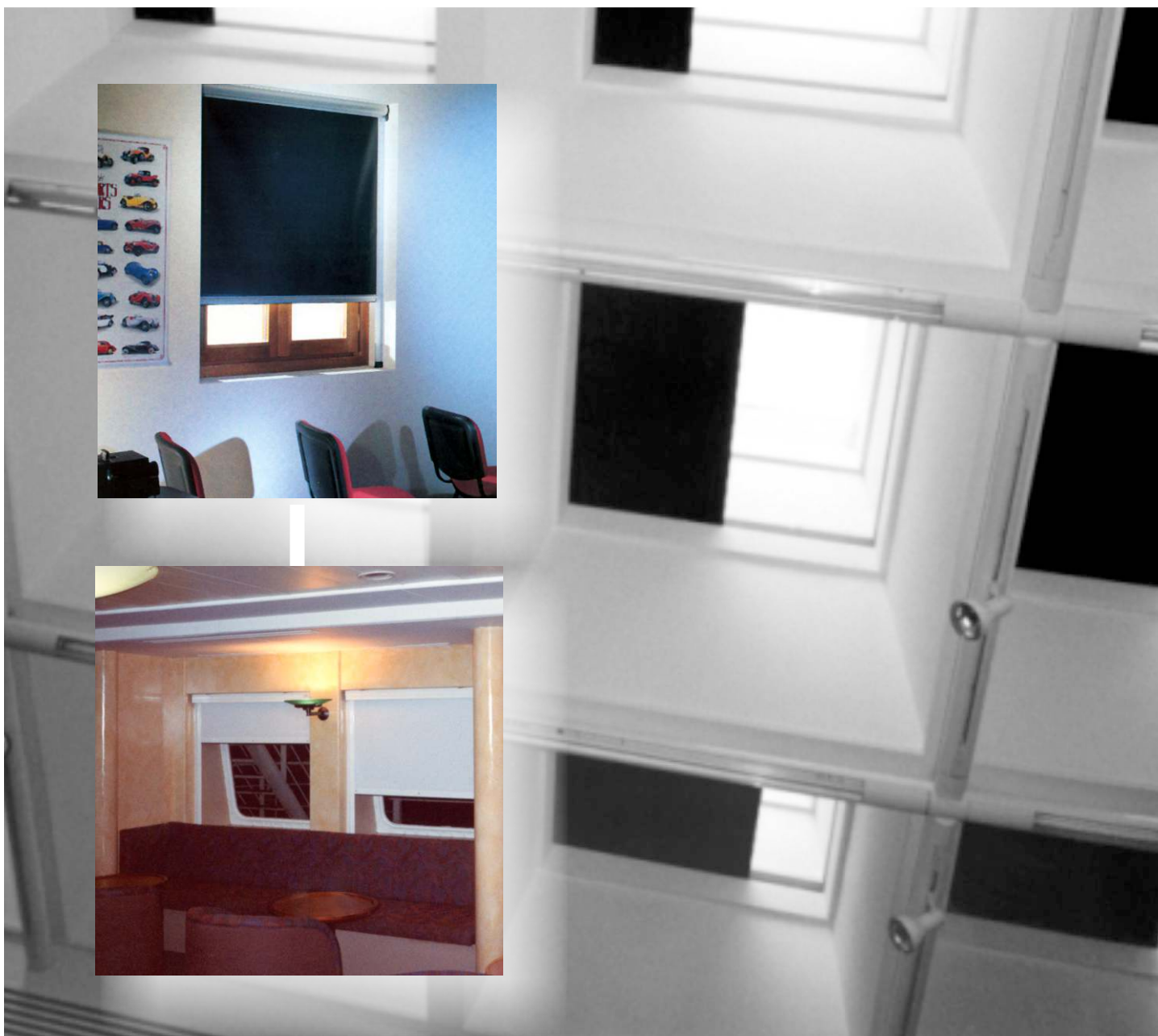

BLACKOUT CASSETTES



Casstyle® blackout blinds



Major Cassette



Blackout cassettes onboard P & O Fantasia

Applications For any application where blacking out of a room is required eg. audio-visual display facilities, entertainment and public buildings.

DESCRIPTION

The range of blackout blinds is based on the Casstyle® cassette roller blind system that has been developed and used in Europe for over 20 years.

It comprises unobtrusive headboxes in 3 sizes with side channels and bottom channels, operated by a choice of system - roller spring, bead chain sidewinder, small gearbox or tubular motor. It can function vertically or on an incline and be recess or face fixed. Also suitable for roller mesh flyscreens and roller projection screens.

Composition, manufacture The Casstyle® headboxes are of extruded aluminium with end caps enclosing the drive mechanism. Side channels are extruded aluminium with brush bar insertions to improve light exclusion, suitable for side or face fixing, supplied in either 23, 40 or 70 mm widths depending on application. For extra security latching feet can be mounted to base of side channels to lock bottom rail in place when blind is closed. Bottom rail is a single extrusion with fabric locked into the profile along a top groove and a brush strip insertion along bottom groove. Blackout material is PVC coated fibreglass which is both flame retardant and washable.

Control options

Spring operation: Suitable for smaller applications, spring mounted on end cap

CONTRACT

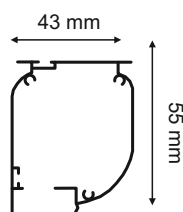

MIDI

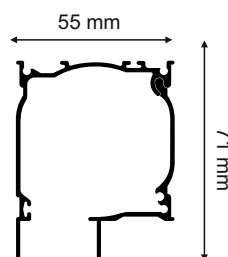

MAJOR

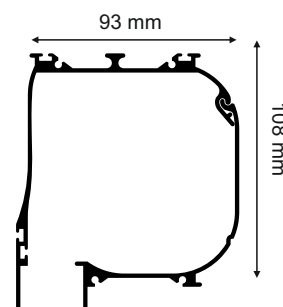

Dimensions (mm)				Max Sizes		Operation			
Headbox	Depth	Height	Barrel Ø	Width	Drop	Electric	Sidewinder	Crank	Spring
Contract	43	55	25	1670	2440		•		•
Midi	55	71	32	2440	2440	•		•	
				1670	1830		•		
Major	85	89	43	5000	6000	•			
				5000	6000			•	

and concealed within roller tube, blind pull closed via handle or pull cord and locked into place under tension using latching feet inserted on base of side channels.

Chain operation: with a bead chain sidewinder positioned left or right, the roller is operated by friction mechanism, this can be spring assisted on larger applications.

Rod/handle operation: operating via a 3:1 ratio gearbox - where the roller is turned once for every 3 turns of the operating handle - control is by a rod incorporating angled cardan joints or by rigid handle connecting to a hook and eye or funnel and pin connector, which enables removal of the handle for security.

Electric operation: is by 40 mm tubular motors operating on a planetary gear

system and fitted with adjustable limit switches. Can also be specified with integrated radio receivers for remote operation. Also available solar powered using our own Solarol® Commercial system. All powered cassette blinds can be operated singularly or grouped and can be integrated with BMS and AV controls systems such as KNX and Control4 .

Appearance

For full blackout all Casstyle® elements must be black, although for room darkening white hardware is available along with a range of fabric colours.

Performance

Fire: Blackout material complies with BS 5867: 1980: Part 2 Type B and conforms to class 0 to BS 476: Part 6 and class 1 to BS 476: Part 7.

New Casstyle® Blackout Cassette



Support British Made
-Designed, extruded & manufactured in the UK



**DESIGNED & MANUFACTURED EXCLUSIVELY BY
FARNBOROUGH BLINDS**

ELECTRIC, GEAR & CHAIN CONTROL OPTIONS

**THICKER, STRONGER PROFILES EXTRUDED IN
THE UK, AVAILABLE WHITE OR BLACK**

SIMPLIFIED FITTING, SAVES TIME ONSITE

**HINGED HEADBOX MEANS BLINDS CAN BE
ACCESSED FOR MAINTENANCE WITHOUT
REMOVING**

**WE STRONGLY BELIEVE IT TO BE THE BEST
SYSTEM CURRENTLY AVAILABLE**



GEAR EXIT MADE NEATER



**SLIDING LOCKING COLLARS
HOLD HEADBOX CLOSED**



**HEADBOX CAN BE OPENED
EVEN AFTER FITTING**



**UTILISES VERTICAL BLIND
BRACKETS FOR FIXING**

CALL NOW FOR MORE INFORMATION
FARNBOROUGH BLIND COMPANY LIMITED

UNIT 7 NORTH DOWNS BUSINESS PARK, LIMEPIT LANE, SEVENOAKS, KENT, TN13 2TL

☎ 01732 456304 📠 01732 453653 ✉ sales@farnboroughblinds.com www.farnboroughblinds.com



FARNBOROUGH BLINDS

Casstyle®

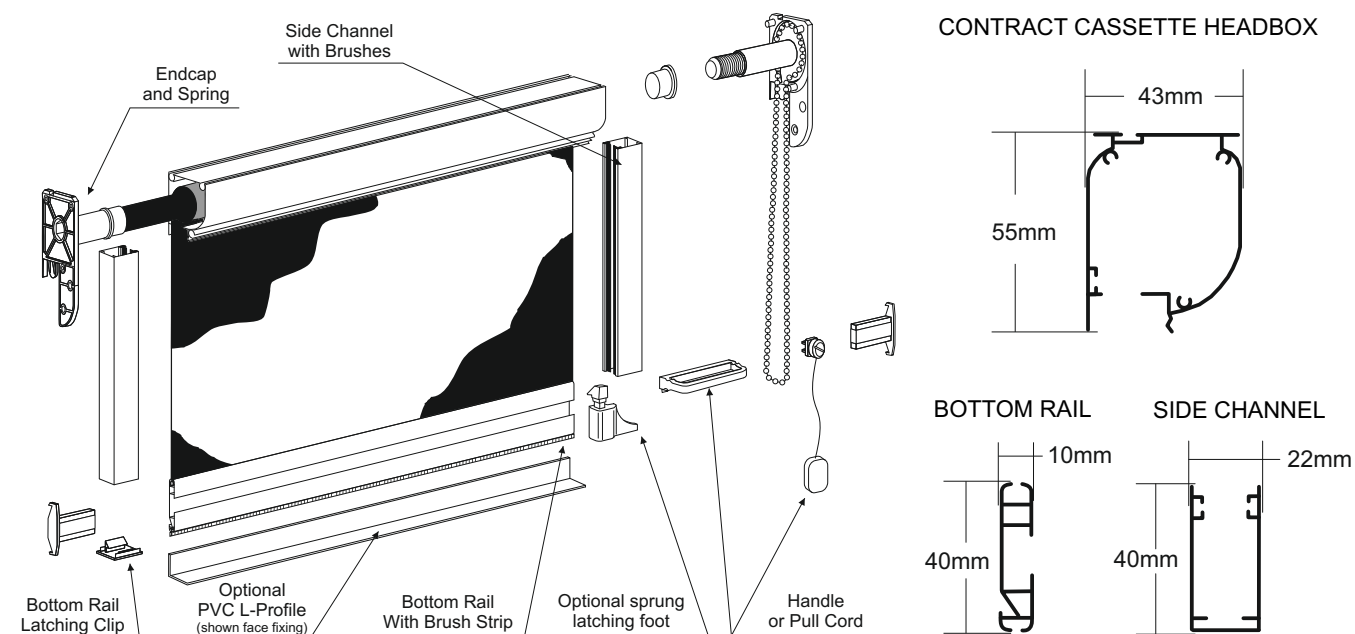

System	Chain	Width	Drop	Area
Contract		Max 2200 mm	Max 2000 mm	3.08 m ²
		Min 300 mm	Min 300 mm	
System	Spring	Width	Drop	Area
Contract		Max 2000 mm	Max 2000 mm	2.802 m ²
		Min 500 mm	Min 400 mm	

0.4	Thickness of fabric (mm)
350	Weight of fabric (g/m ²)
300	Bottom bar weight (g/m)

		Width (m)								
		0.6	0.8	1.0	1.2	1.4	1.6	1.8	2.0	2.2
Drop (m)	0.6									
	0.8									
	1.0									
	1.2									
	1.4									
	1.6									
	1.8									
	2.0									

Maximum sizes -For larger applications see Midi system



CASSTYLE® CONTRACT CASSETTE FRAME COLOURS ARE STANDARD WHITE OR BLACK

FABRIC IS BLACK (REQUIRED FOR TOTAL BLACKOUT) OR WHITE FLAME RETARDENT PVC COATED FIBREGLASS

OPTIONAL SPRING ONLY OPERATION AVAILABLE ON REQUEST

CAN BE MANUFACTURED AS A SKYLIGHT SYSTEM FOR VELUX STYLE WINDOWS

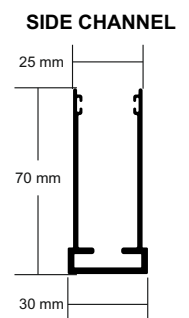
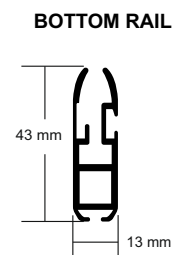
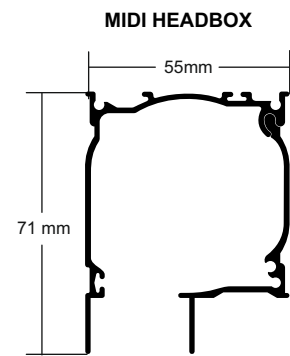
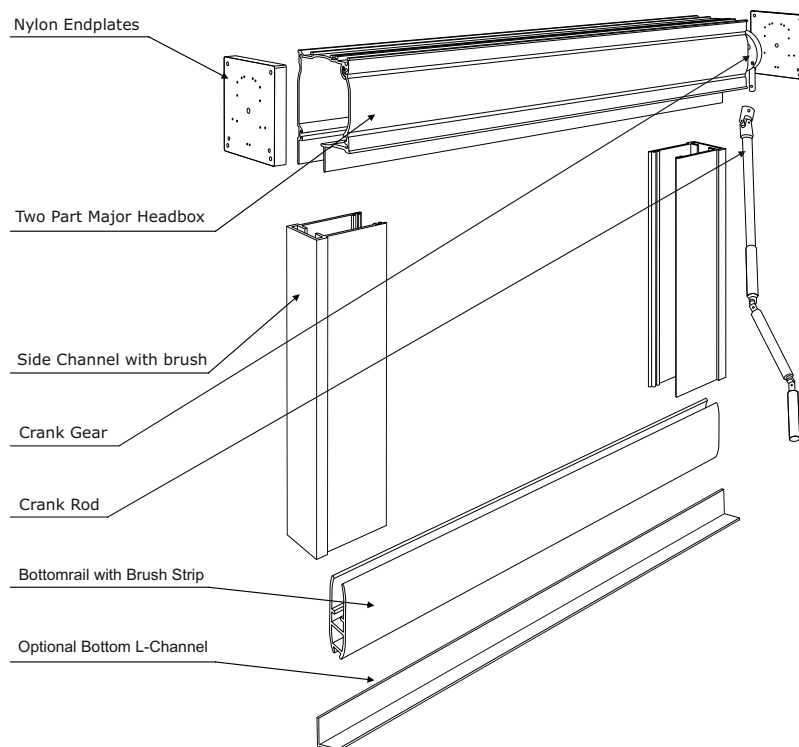

System	Chain	Width	Drop	Area
MIDI		Max 2200mm	Max 2000mm	3.08 m ²
		Min 300mm	Min 300mm	

System	Gear	Width	Drop	Area
MIDI		Max 2000mm	Max 2000mm	4.32 m ²
		Min 500mm	Min 400mm	

System	Electric	Width	Drop	Area
MIDI	24v DC	Max 2000mm	Max 2000mm	4.32 m ²
		Min 500mm	Min 400mm	

0.4	Thickness of fabric (mm)
350	Weight of fabric (g/m)
300	Bottom bar weight (g/m)

		Width (m)									
		0.6	0.8	1.0	1.2	1.4	1.6	1.8	2.0	2.2	2.4
Drop (m)	0.6										
	0.8										
	1.0										
	1.2										
	1.4										
	1.6										
	1.8										
	2.0										
	2.2										
	2.4										
	2.6										

Maximum sizes -For larger applications see Major system



AVAILABLE IN WHITE OR BLACK FINISH ONLY. FOR TOTAL LIGHT EXCLUSION (BLACKOUT), BLACK FINISH IS NECESSARY
CASSETTES ARE AVAILABLE FREE-HANGING (WITHOUT SIDE CHANNELS)

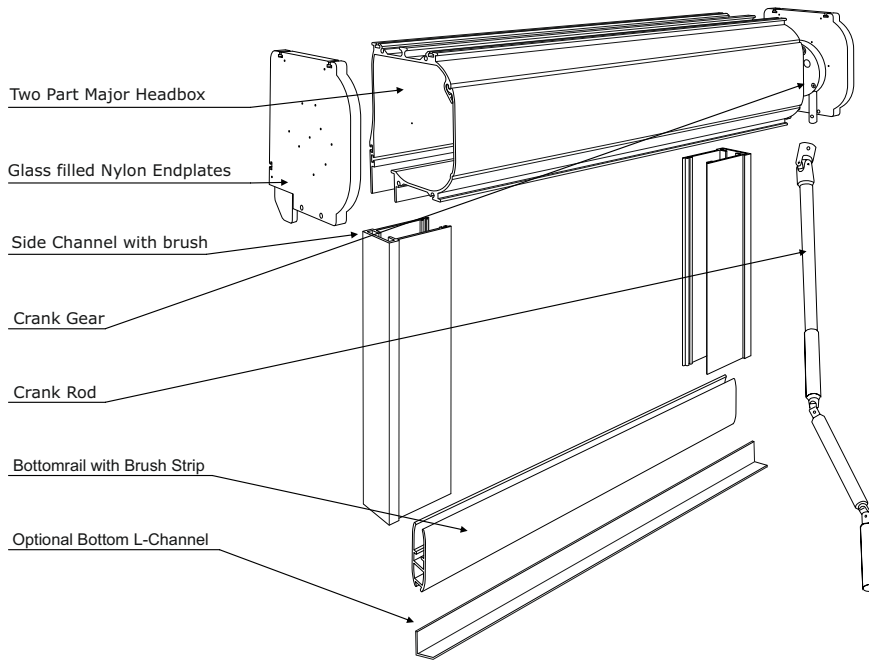

MAJOR HEADBOX

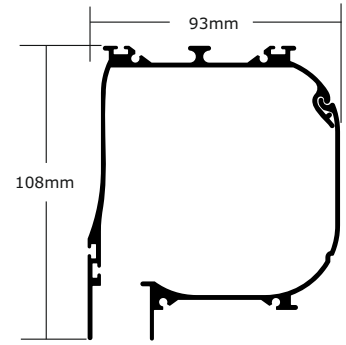

BOTTOM RAIL

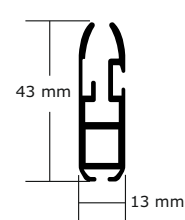

SIDE CHANNEL

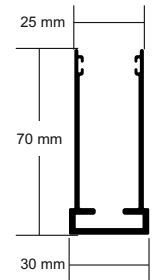

System	Chain	Width	Drop	Area
MAJOR		Max 3400 mm Min 300 mm	Max 4000 mm Min 300 mm	12.2 m ²

System	Gear	Width	Drop	Area
MAJOR		Max 3600 mm Min 400 mm	Max 6000 mm Min 400 mm	20.8 m ²

System	Electric	Width	Drop	Area
MAJOR	240v AC	Max 4000 mm Min 570 mm	Max 6000 mm Min 400 mm	20.8 m ²

0.4	Thickness of fabric (mm)
350	Weight of fabric (g/m ²)
300	Bottom bar weight (g/m)



Width (m)		0.6	0.8	1.0	1.2	1.4	1.6	1.8	2.0	2.2	2.4	2.6	2.8	3.0	3.2	3.4	3.6	3.8	4.0
Drop (m)	0.6																		
	0.8																		
	1.0																		
	1.2																		
	1.4																		
	1.6																		
	1.8																		
	2.0																		
	2.2																		
	2.4																		
	2.6																		
	2.8																		
	3.0																		
	3.2																		
	3.6																		
	3.8																		
	4.0																		
	4.2																		
	4.4																		
	4.6																		
	4.8																		
	5.0																		
	5.2																		
	5.4																		
	5.6																		
	5.8																		
	6.0																		

■ Gear/Electric Operation only (not possible as chain control)

Casstyle® M98 Dim-out Zipa Cassette

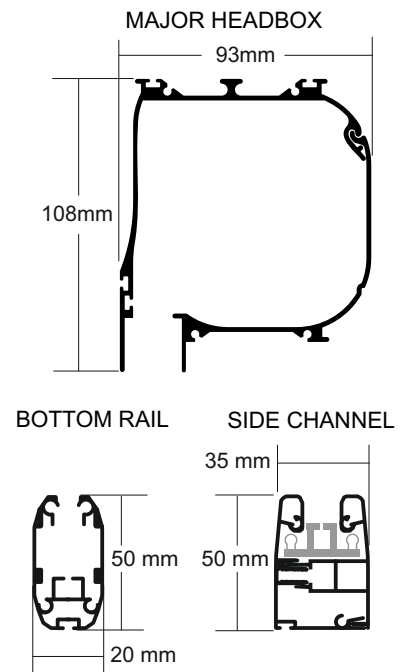
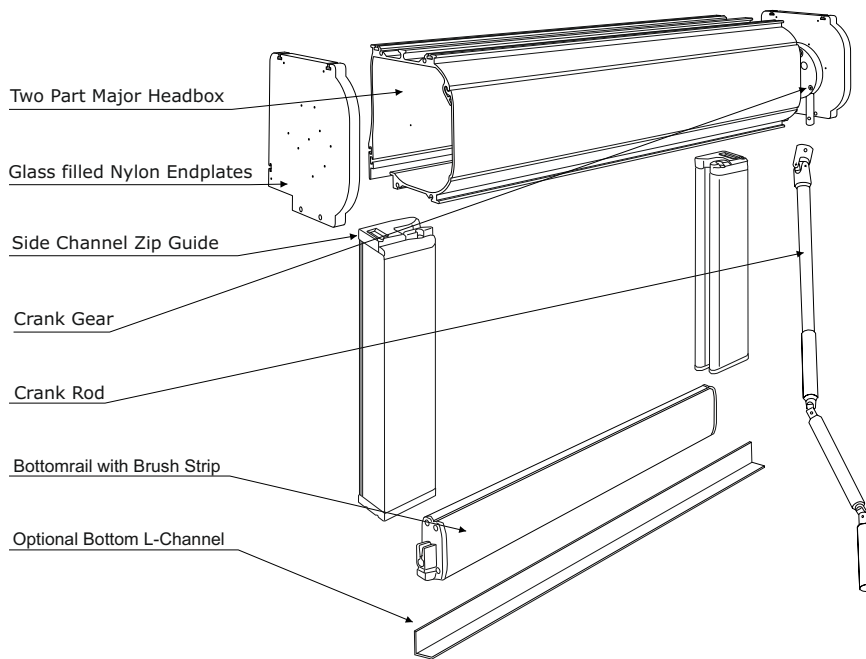

System	Gear	Width	Drop	Area
M98		Max 3600mm Min 400mm	Max 6000mm Min 400mm	20.8 ² m

System	Electric	Width	Drop	Area
M98	240v AC	Max 4000mm Min 570mm	Max 6000mm Min 400mm	20.8 ² m

0.4	Thickness of fabric (mm)
350	Weight of fabric (g/m ²)
300	Bottom bar weight (g/m)



		Width (m)																		
		0.6	0.8	1.0	1.2	1.4	1.6	1.8	2.0	2.2	2.4	2.6	2.8	3.0	3.2	3.4	3.6	3.8	4.0	
Drop (m)	0.6																			
	0.8																			
	1.0																			
	1.2																			
	1.4																			
	1.6																			
	1.8																			
	2.0																			
	2.2																			
	2.4																			
	2.6																			
	2.8																			
	3.0																			
	3.2																			
	3.4																			
	3.6																			
	3.8																			
	4.0																			
	4.2																			
	4.4																			
	4.6																			
	4.8																			
	5.0																			
	5.2																			
	5.4																			
	5.6																			
	5.8																			
	6.0																			

■ Gear/Electric Operation only (not possible as chain control)