

VERTICAL BLIND FITTING AND CLEANING INSTRUCTIONS

Please read these instructions before attempting to fit your blind

Before attempting to fit your blind please check the following is included:

A cord/chain safety device, correct bracket type and fixing screws.

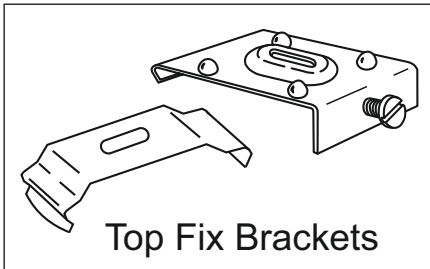

Fix brackets to ceiling or lintel with holes drilled in a line at least 75mm from the wall or window frame for blinds with 127mm louvres, or 50mm for blinds with 89mm louvres.

End brackets should be about 40mm from the ends of the track. Any remaining brackets should be spaced evenly between these brackets.

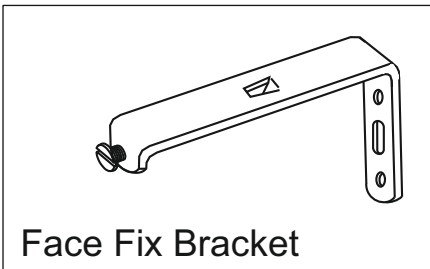

Fix brackets to wall or window frame as closely as possible to the ceiling or lintel, with the same spacing recommended above for top fixing brackets

FITTING THE TRACK

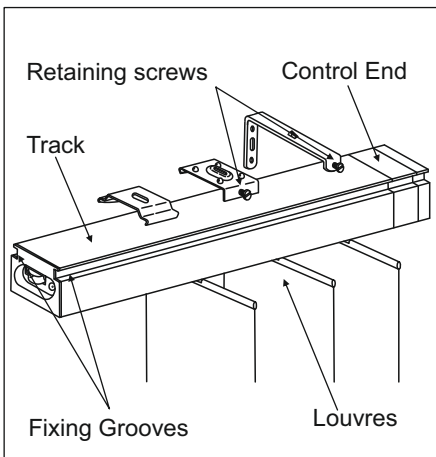

The track must be fitted into brackets keeping controls to side required. Locate the small lip projecting from brackets into groove on track. Push up into brackets. Spring clip brackets will hold your track without further adjustment. If your brackets have retaining screws these should now be tightened into the front slot on the track. (DO NOT OVER-TIGHTEN RETAINING SCREWS- This is unnecessary and will damage the track).

Remove packing material from track releasing the cord and chain.

Now test the operation of track, the cord control should slide carriers and the chain should rotate them.

HANGING THE LOUVRES

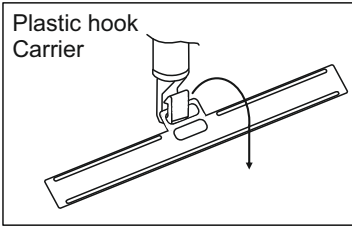

Using the chain control, turn all hooks so that the slots are 90° to the track.

Tracks with Plastic Hook carriers, hold louvre hangers horizontal, twist into hooks and pull down (see diagram).

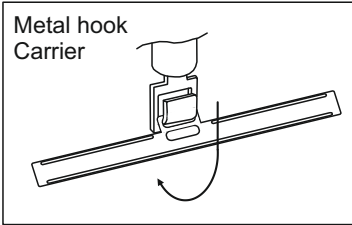

Tracks with metal hook carriers, hold hangers horizontal and slide into metal hook, then twist straight, ensuring the hanger now lies straight (see diagram)

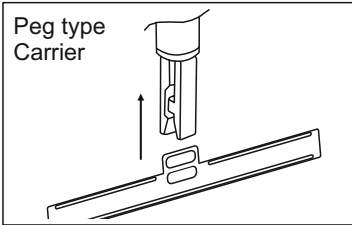

Tracks with peg type carries, hold hangers vertical, push straight up into peg making sure the hanger clips into place (see diagram) Hang louvres keeping all seams the same way. Your blind is now ready to operate

IMPORTANT: DO NOT TRAVERSE BLIND WITH LOUVRES IN CLOSED POSITION. ALWAYS TURN THEM 90° TO THE TRACK BEFORE OPERATING CORD CONTROL.

WARNING

Young children can be strangled by loops in pull cords, chains, tapes and inner cords that operate the products.

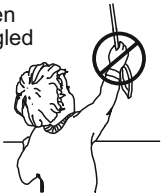

To avoid strangulation and entanglement, keep cords out of reach of young children.

Cords may become wrapped around a child's neck.

Move cots and furniture away from window covering cords.

Do not tie cords together. Make sure cords do not twist and create a loop.

Securing the chain and cord loop

To protect small children from strangulation, it is now a **legal requirement** to secure the chain and cord loop controls using the attached plastic retention device.

1. Pull the retention device down to the wall or window frame so that there is no slack in the chain and cord, but not so tight as to impede operation.
2. Mark the screw position and drill hole for screw or wall plug.
3. Attach the tie-down device with screw provided and test operation and safety.

