

HANGING YOUR NEW VENETIAN BLIND

Your new Venetian Blind has been made up to your measurements and tested before leaving our factory.

To Install your blind you will need: Drill, Tape measure and Screwdriver
1½" No. 6 screws for plaster/concrete fixing
¾" No. 6 screws for timber fixing
Wall plugs if required

CAUTION: USE PROPER EYE PROTECTION WHEN DRILLING MOUNTING HOLES.

NOTE: WIDE BLINDS MAY REQUIRE MORE THAN ONE PERSON TO INSTALL.

Ensure the fixing surface is firm and level. Choose the position of your blind allowing space front and back to prevent window catches etc. Hindering the movement of your blind.

Carefully remove blind from packaging, being aware not to damage blind if cutting open packaging with a knife or scissors.

Unless otherwise specified you will have been supplied with the correct number of Swivel Brackets (see figure 1), for the width of your blind. A bracket should be placed approximately 75mm (3") in from each end of the head rail and the remainder spread in between no more than 800mm (31") apart.

For blinds exceeding 4 square metres an additional bracket either side or the cord lock is recommended to give extra strength.

IMPORTANT: BRACKETS MUST NOT INTERFERE WITH THE MOVEMENT OF COMPONENTS INSIDE THE HEADRAIL, THIS SHOULD BE CONSIDERED WHEN PLACING BRACKETS.

Ensure the swivel section of the brackets are in the open position (see figure 2), offer up the headrail and lock swivels (see figures 3 and 4). You have now successfully installed your blind, before operating your blind please read the instructions on 'Using your new Venetian blind' over page.

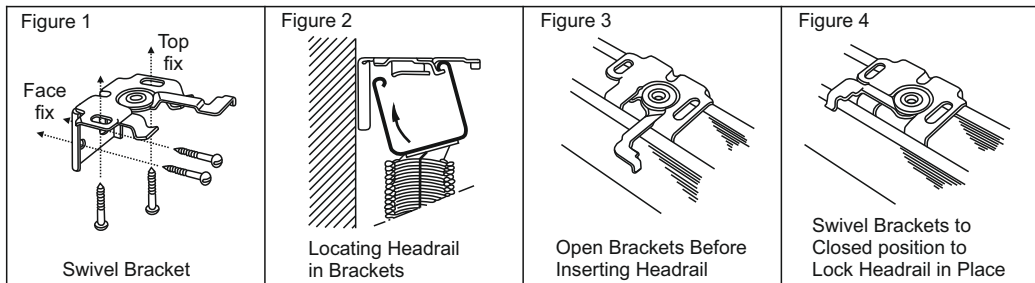

Securing the blind cords: To protect small children from strangulation, it is now a **legal requirement** to secure the blind chain and or cord loop controls out of reach. All blinds are delivered with one or more cord cleats to be installed at the side of the wall as close to the headrail as possible and, in all cases, not less than 1.5 metres from the floor. Control cords need to be wrapped around the cleat until they are inaccessible to children, if necessary two cleats should be used, one above the other, to fully gather all the cord.

1. Place the safety cleat in the desired location on the wall and mark the position of the fixing holes using a pencil. The cleat(s) should be positioned adjacent to the cord exits on the head rail and high enough to be out of the reach of children, and at least 1.5 metres from the floor.

2. Remove the safety cleat and drill the positions marked. Once the holes are drilled place a wall plug into the holes, and secure cleat with screws provided.

At all times when the blind is not being used the cords should be wrapped around the safety cleat(s) in a figure of eight pattern, as shown in the picture right.

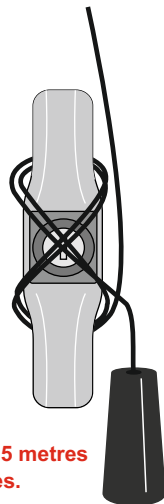

For child safety reasons headrails with cord controls must not be installed less than 1.5 metres from the floor. Please contact your supplier for advice if you are fitting below 1.5 metres.

USING YOUR NEW VENETIAN BLIND

Your Venetian Blind will give you many years trouble free service so long as it is correctly installed and operated. By following these simple instructions you can be confident you are operating your blind correctly and safely.

Wand Tilt Operation: By twisting the clear wand in either direction the angle of slatting can be adjusted to match the angle of the sun (see diagram above). Care should be taken not to over-twist the clear wand as this can cause it to unhook from the blind. Should this happen the hook end can be easily clipped back into place. It is also recommended that the wand is not bent tightly as this may leave it permanently curved.

Cord Tilt: Using both hands (see diagram right), gently pull either cord. If the slats do not tilt in the desired direction, gently pull other cord. (Please read the safety instructions over page on keeping cords out of reach of children).

Pull Cord: To raise the blind, set the slats horizontally and draw the pull cord straight down until the blind is at the desired height, (see diagram below). When tension is released from the cord the automatic cord lock will hold the blind in the desired position. To lower the blind, pull the cord towards the centre of the blind to release the cord lock, and let the cord glide through your hand.

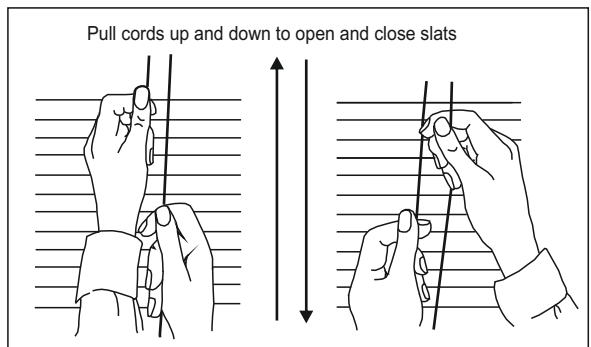
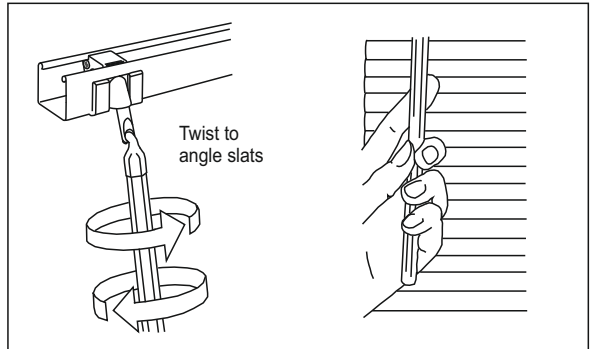

WARNING

Young children can be strangled by loops in pull cords, chains, tapes and inner cords that operate the products.



To avoid strangulation and entanglement, keep cords out of reach of young children.

Cords may become wrapped around a child's neck.

Move beds, cots and furniture away from window covering cords.

Do not tie cords together. Make sure cords do not twist and create a loop.

